

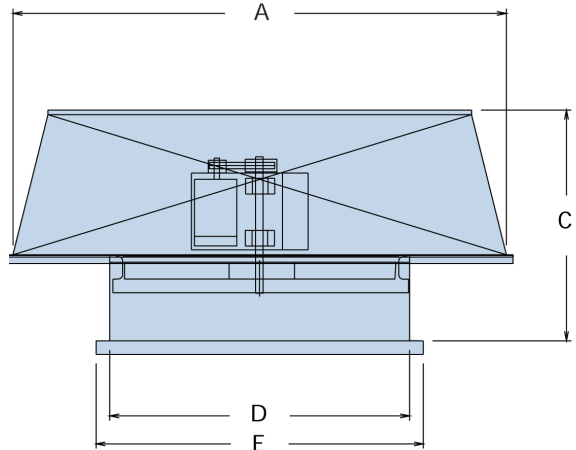

**Model HS**  
**Hooded Power Ventilator**

- Belt drive power roof ventilator-specify exhaust or supply application.
- Heavy duty six-bladed steel propeller
- Angle drive frame bolted to base assembly provides firm base and accurately aligns power assembly.
- Variable pitch drives to 7-1/2 Hp.
- Industrial duty ball bearing motor.
- Self-aligning pillow block bearings.
- Galvanized hood and all welded base assembly with protective urethane finish.
- Hinged hood for easy access to motor and drives.
- 1/2 mesh galvanized birdscreen.
- Tested and rated in accordance with AMCA Standard 211

**ROMLA VENTILATOR CO.**  
**9668 Heinrich Hertz Drive • Unit D**  
**San Diego, California 92154**  
**Ph (619) 946-1224 Fax (619) 946-1227**

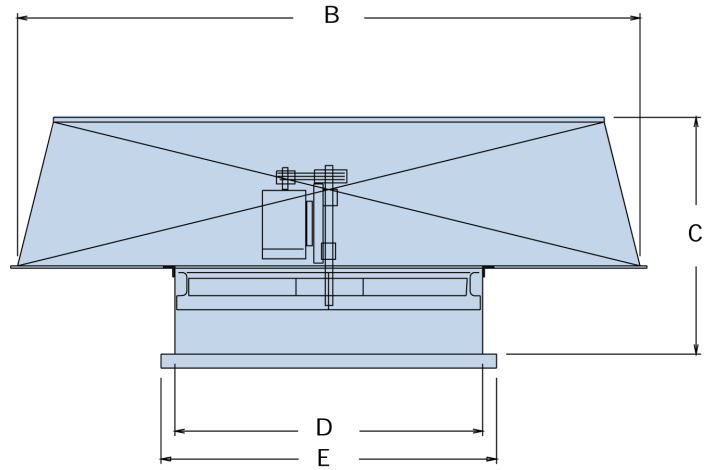

**Abbreviation for Accessories**

- DS -Safety disconnect switch
- CF8 -Type CF roof curb 8" high
- SF8 -Type SF roof curb 8" high
- CF12 -Type CF roof curb 12" high
- SF12 -Type SF roof curb 12" high
- 611 -Automatic exhaust damper
- 611M -Motorized exhaust damper 1/115v
- 613 -Automatic supply damper
- VC-1 -Motorized supply damper 1/115v
- EC -Epoxy coating

FAN SIZE	A	B	C	D	E	BASE GAUGE	HOOD GAUGE	WT
24	51	51	24	30.25	36	16	20	196
30	60	60	24	36.25	42	16	20	260
36	71	71	28	42.25	48	16	20	375
42	81	81	30	48.25	54	16	20	500
48	91	91	31	54.25	60	14	20	650
54	99	99	34	60.25	66	14	18	775
60	99	120	35	66.25	72	14	18	900

**SPECIFICATIONS**

QTY	MODEL NO.	TAG	CFM	SP	RPM	HP	VOLTS	PH	HZ	TYPE	APPLIC	OPTION

<p><b>PROJECT:</b> <b>LOCATION:</b> <b>SUBMITTED BY:</b> <b>DATE:</b></p>	<p><b>CONTRACTOR:</b> <b>ENGINEER:</b> <b>APPROVED BY:</b> <b>DATE:</b></p>
---	---